

Saunders and Miller Streets, Pyrmont

Walking and cycling improvements

01

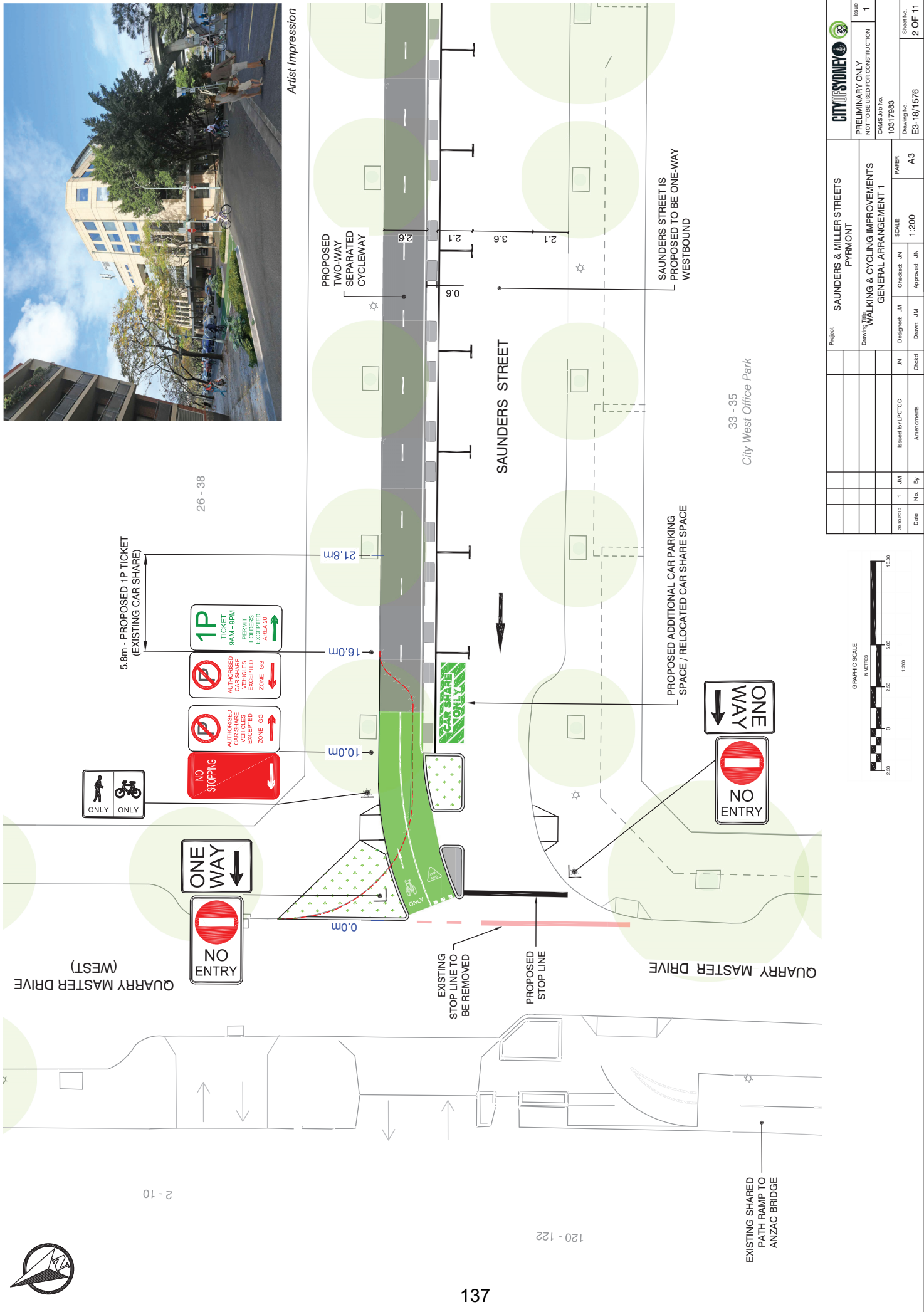



Project: SAUNDERS & MILLER STREETS PYRMONT		Issue: 1	
Drawing Title: WALKING & CYCLING IMPROVEMENTS GENERAL ARRANGEMENT 1		PRELIMINARY ONLY NOT TO BE USED FOR CONSTRUCTION	
Date: 26/12/2019	1 J/M	Issued for: LPTCC	CAMS Job No: 10317983
Date: 11/01/20	1 J/M	Checked: J/M	Drawing No: EG-18/1576
Date: 11/01/20	1 J/M	Approved: J/M	Scale: 1:200
Date: 11/01/20	1 J/M	Checked: J/M	Sheet No: 2 OF 11
Date: 11/01/20	1 J/M	Approved: J/M	Sheet No: 2 OF 11

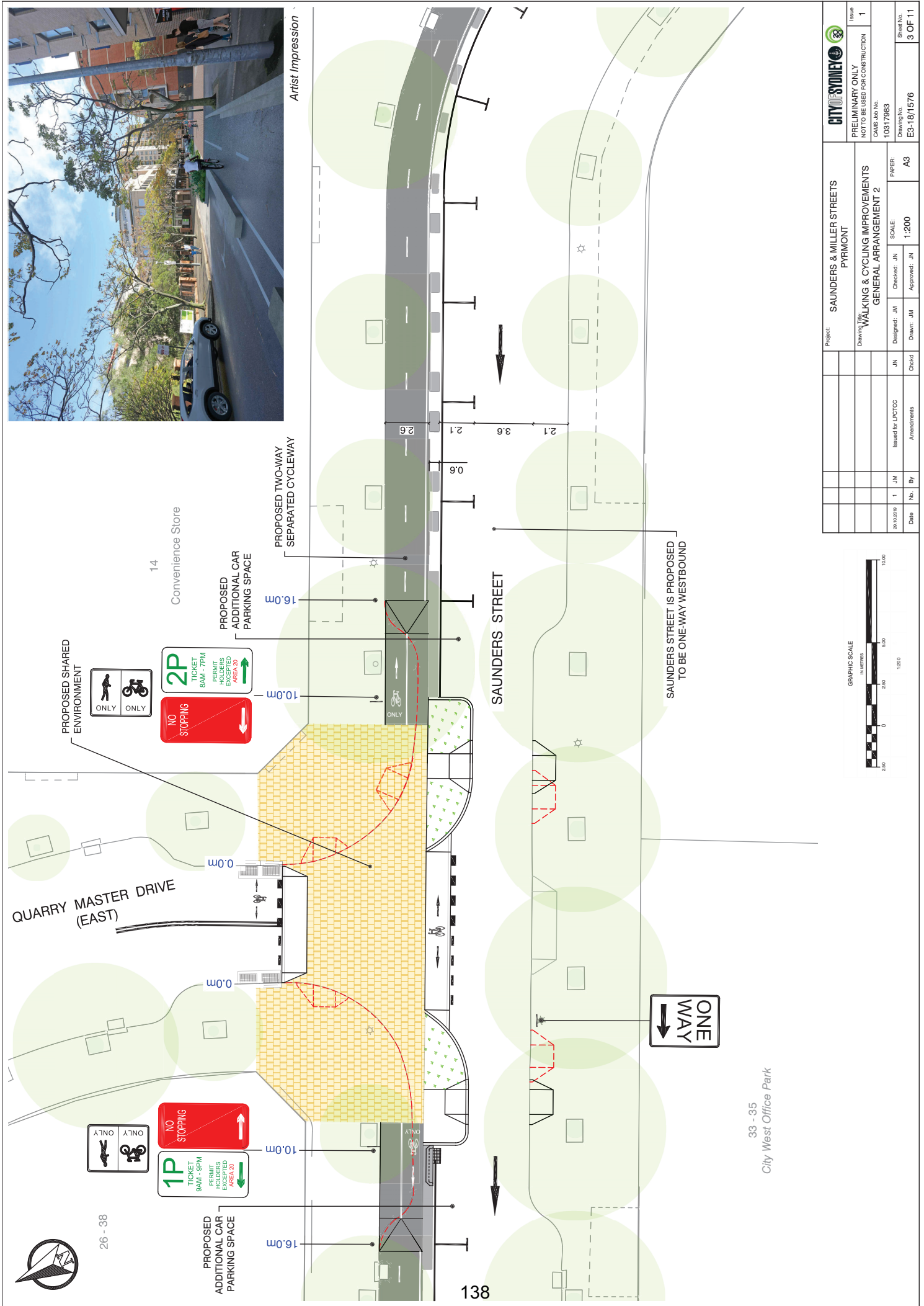

26 - 38

14

Artist Impression

138

33 - 35
City West Office Park



Project: SAUNDERS & MILLER STREETS PYRMONT		Issue: 1	
Drawing: WALKING & CYCLING IMPROVEMENTS GENERAL ARRANGEMENT 2		Status: PRELIMINARY ONLY NOT TO BE USED FOR CONSTRUCTION	
Drawn: JM	Checked: JM	Scale: 1:200	Paper: A3
Designed: JM	Checked: JM	Drawn: JM	Approved: JM
Issued for LPO/DOC: JM	Checked: JM	Drawn: JM	Approved: JM
Date: 26/10/2019	No.:	By:	Sheet No. 3 OF 11
Amendments:			Street No. E3-18/1576
			Drawing No. 10317983
			COAG Job No. 10317983

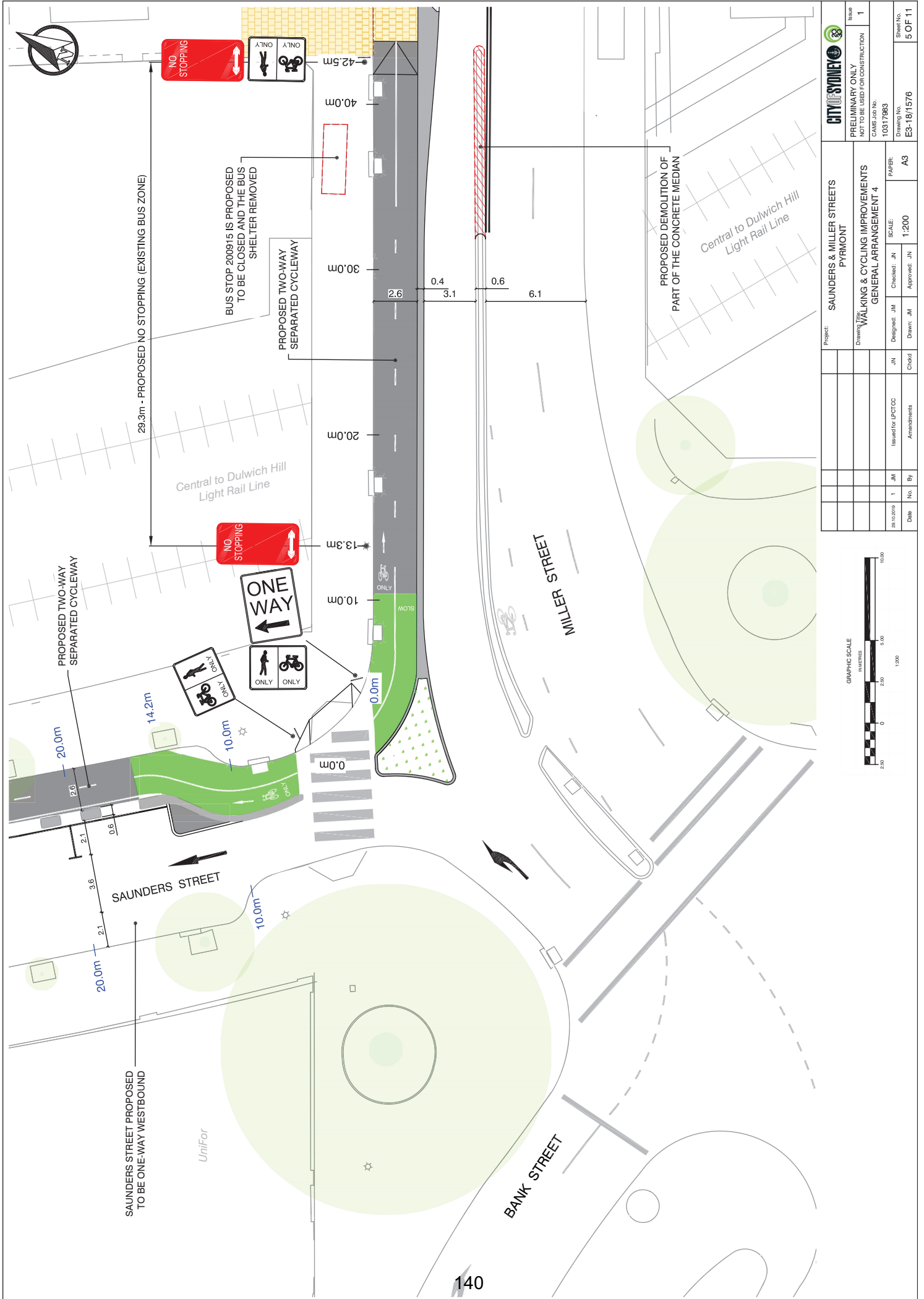

CONTINUES ON GENERAL ARRANGEMENT 3

Project: SAUNDERS & MILLER STREETS PYRMONT		Issue: 1	
Drawing Title: WALKING & CYCLING IMPROVEMENTS GENERAL ARRANGEMENT 4		PRELIMINARY ONLY NOT TO BE USED FOR CONSTRUCTION	
Checked: JN		CAMS Job No.: 10317983	
Designed: JM		Drawing No.: E3-18/H576	
Date: 29/10/2019		Sheet No.: 5 OF 11	
Issued for I/PTCC		Paper: A3	
Amendments		Scale: 1:200	
By: JM		Approved: JN	
No.		Drawn: JM	
Date		Checked: JN	

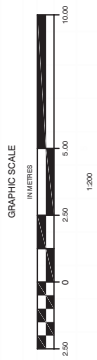

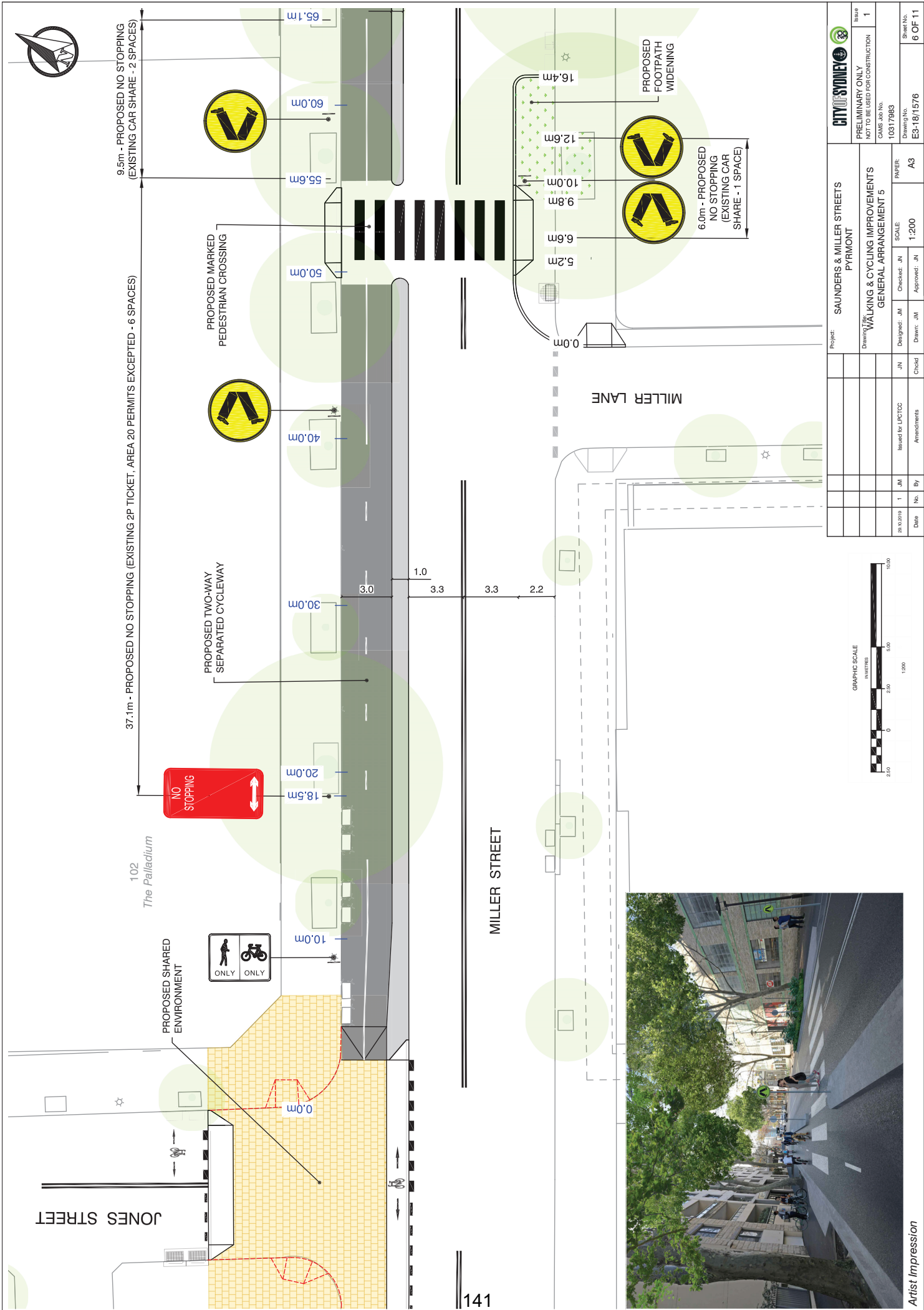

JONES STREET

102
The Palladium

MILLER STREET

MILLER LANE

141



Artist Impression

9.5m - PROPOSED NO STOPPING
(EXISTING CAR SHARE - 2 SPACES)

37.1m - PROPOSED NO STOPPING (EXISTING 2P TICKET, AREA 20 PERMITS EXCEPTED - 6 SPACES)

PROPOSED MARKED
PEDESTRIAN CROSSING

PROPOSED TWO-WAY
SEPARATED CYCLEWAY

PROPOSED SHARED
ENVIRONMENT

ONLY ONLY

PROPOSED
FOOTPATH
WIDENING

6.0m - PROPOSED
NO STOPPING
(EXISTING CAR
SHARE - 1 SPACE)

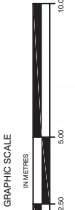

Project: SAUNDERS & MILLER STREETS
PYRMONT

Issue	1	
PRELIMINARY ONLY NOT TO BE USED FOR CONSTRUCTION		
CAHS Job No.	10017983	
Drawing No.	E3-18/1576	
Sheet No.	6 OF 11	
Scale	A3	
Scale	1:200	
Checked: JM	Approved: JM	
Designed: JM	Drawn: JM	
Issue for LPCTCC	Amendments	
Date	No.	By
26.10.2019	1	JM

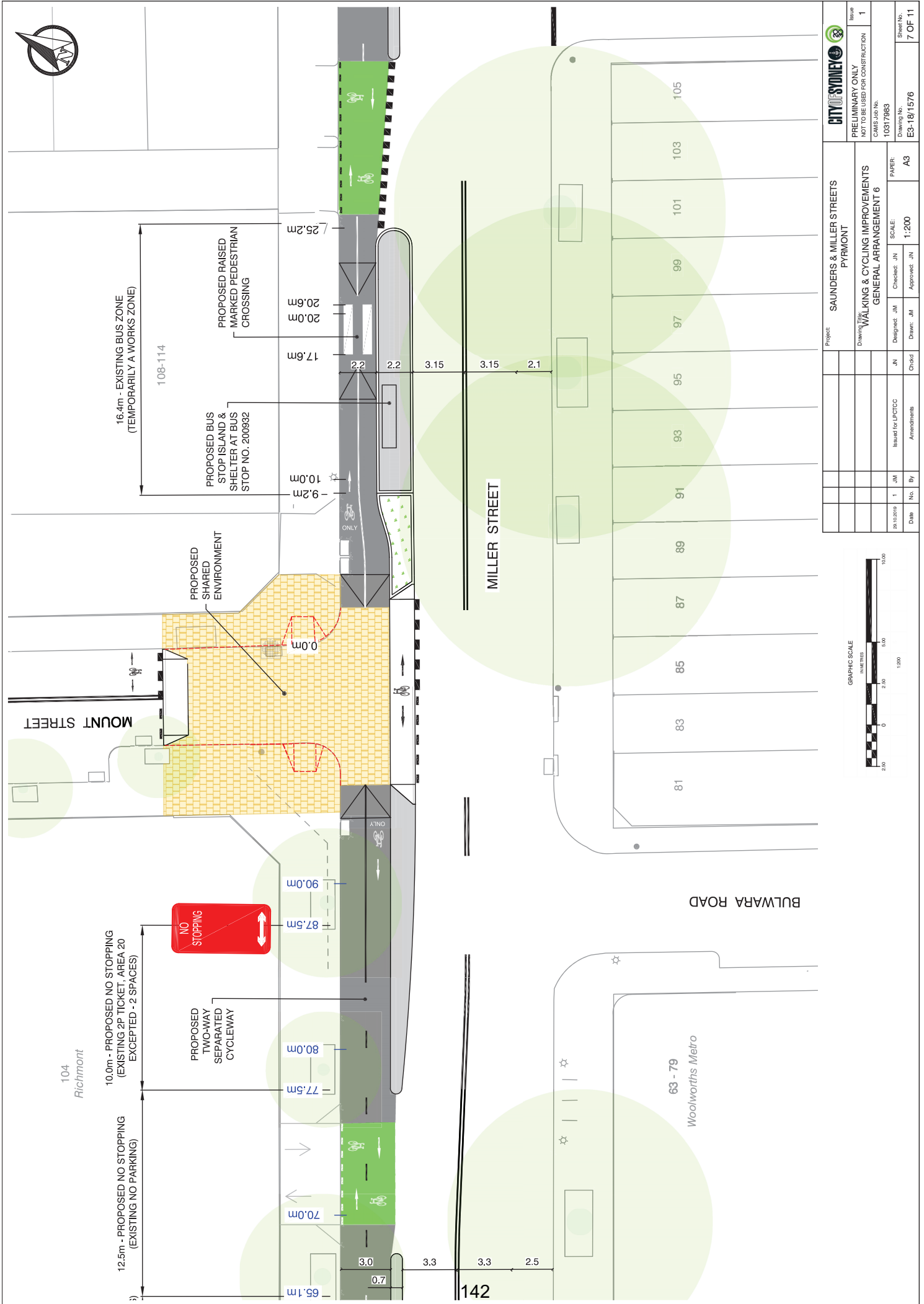

Project: SAUNDERS & MILLER STREETS PYRMONT	Issue: 1
Drawing Title: WALKING & CYCLING IMPROVEMENTS GENERAL ARRANGEMENT 6	Status: PRELIMINARY ONLY NOT TO BE USED FOR CONSTRUCTION
Design: JN	Check: JN
Draw: JN	Approve: JN
Date: 26/10/2019	Scale: 1:200
Issued for LPT/DC	Paper: A3
Amendments	Drawing No: 10037983
Date No. By	Sheet No: 7 OF 11
Date No. By	Approved: JN
Date No. By	Checked: JN
Date No. By	Drawn: JN
Date No. By	Approved: JN
Date No. By	Checked: JN
Date No. By	Drawn: JN
Date No. By	Approved: JN
Date No. By	Checked: JN
Date No. By	Drawn: JN
Date No. By	Approved: JN

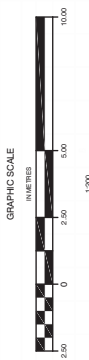

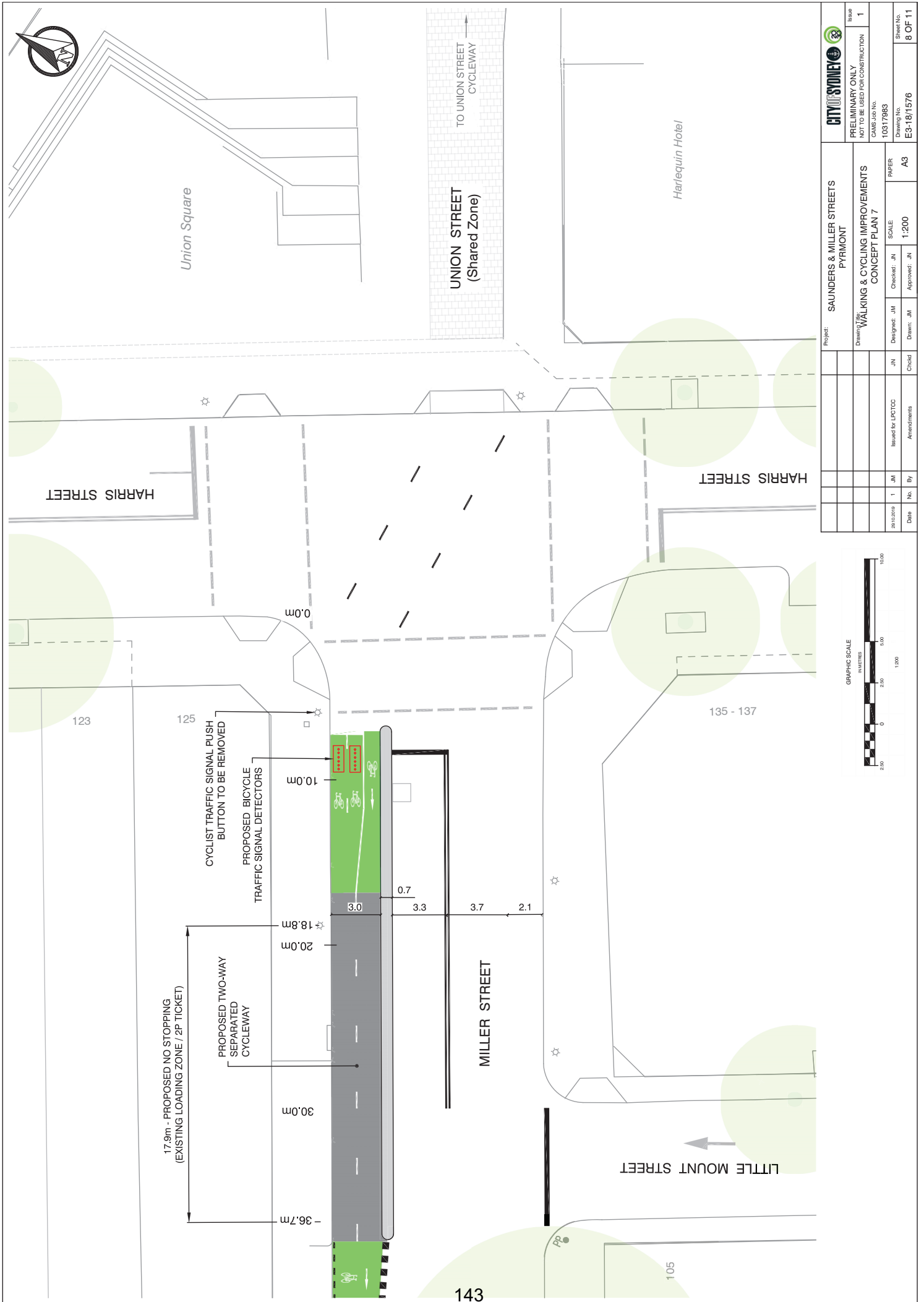

Project: SAUNDERS & MILLER STREETS PYRMONT Drawing Title: WALKING & CYCLING IMPROVEMENTS CONCEPT PLAN 7 Scale: 1:200 Checked: JN Approved: JN Drawn: JM Date: 28/10/2019 No. 1 By JM Amendments:	Issue: 1 PRELIMINARY ONLY NOT TO BE USED FOR CONSTRUCTION CAMS Job No. 10317983 Drawing No. E3-18/1576 Sheet No. 8 OF 11

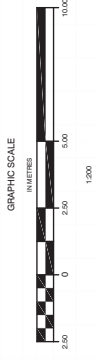

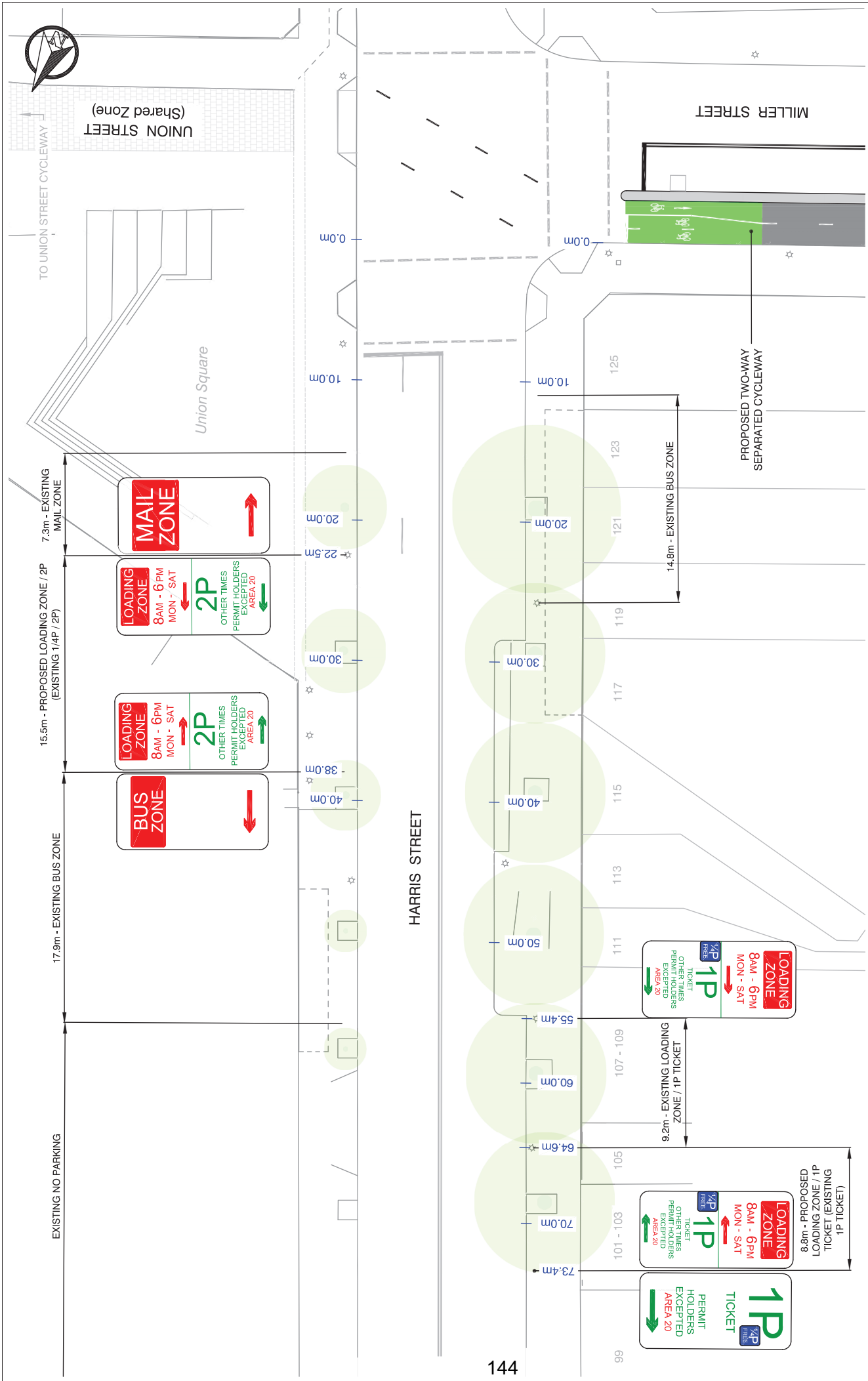

Project: SAUNDERS & MILLER STREETS PYRMONT		Issue: 1	
Drawing Title: WALKING & CYCLING IMPROVEMENTS GENERAL ARRANGEMENT 8		Status: PRELIMINARY ONLY NOT TO BE USED FOR CONSTRUCTION	
Drawn: JM	Checked: JM	Scale: 1:250	Sheet No. 9 OF 11
Design: JM	Checked: JN	Scale: A3	Sheet No. E3-18/1576
Date: 26-10-2019	By: JN	Issued for: LDC/CC	City of Sydney
Date: 11-01-2020	By: JN	Amendments:	CAHS Job No. 10017983
Date: 11-01-2020	By: JN	Amendments:	Drawing No. E3-18/1576

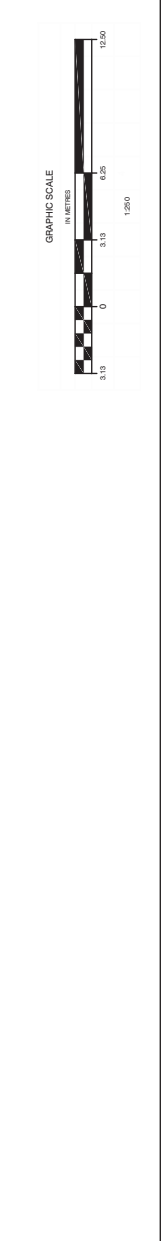

TYPICAL CROSS SECTIONS

MILLER STREET

12.8 m WIDE KERB TO KERB
20.0 m WIDE ROAD RESERVE

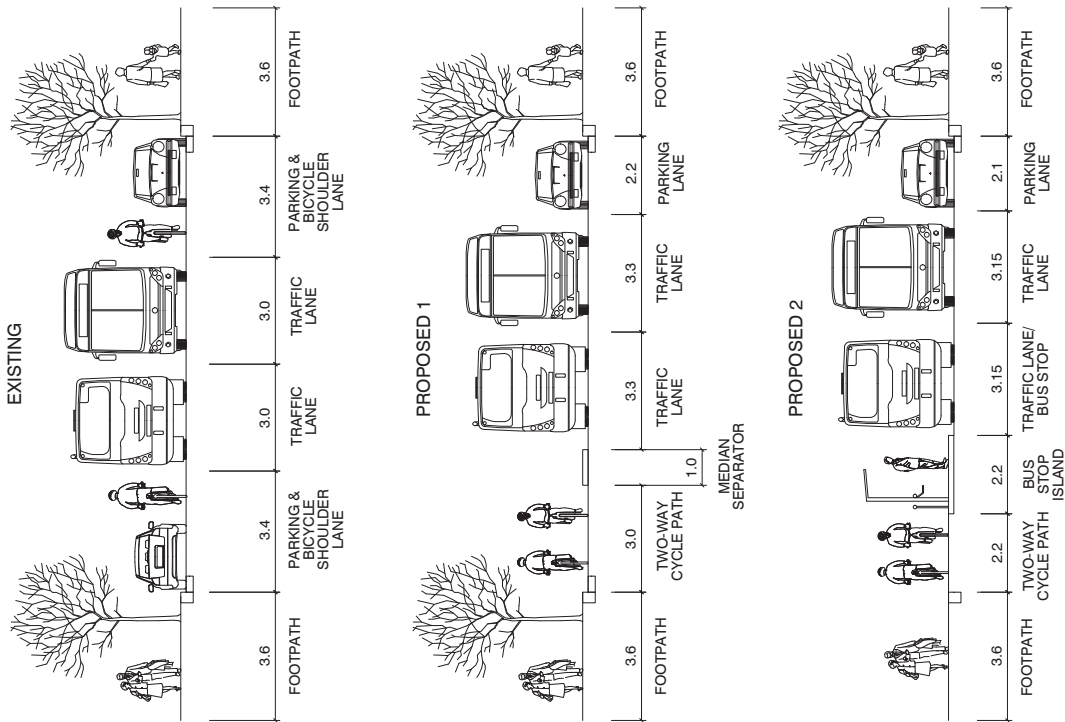

SAUNDERS STREET

11.0 m WIDE KERB TO KERB
20.0 m WIDE ROAD RESERVE

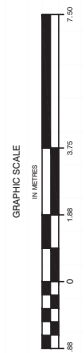
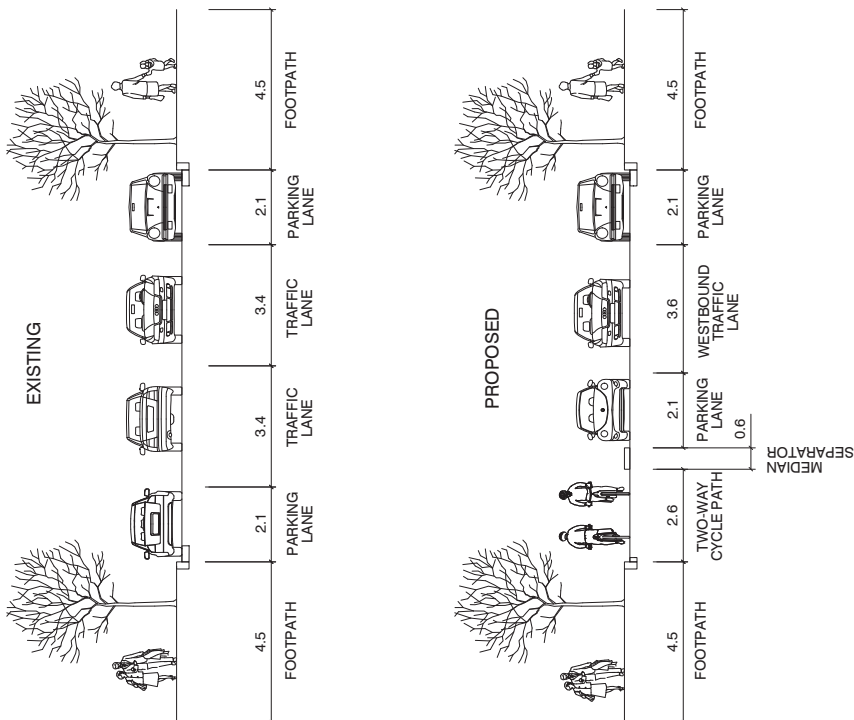

Project: SAUNDERS & MILLER STREETS PYRMONT		City of Sydney	
Drawing Title: WALKING & CYCLING IMPROVEMENTS TYPICAL CROSS SECTIONS		Issue: 1	Scale: A3
Date: 26/10/2019	By: JIM	Checked: JIM	Drawn: JIM
Date: 26/10/2019	By: JIM	Checked: JIM	Drawn: JIM
Issued for LDC/DOC		Scale: 1:100	Sheet No. 10 OF 11
Amendments		Approved: JIM	10 OF 11
CADS Job No. 10017983		Drawing No. E3-18/1576	
PAPER			
NOT TO BE USED FOR CONSTRUCTION			
PRELIMINARY ONLY			



LEGEND	
STANDARD PARKING SPACES	
█	EXISTING PARKING SPACES TO BE REMOVED (-6)
█	NEW ON-STREET PARKING SPACES TO BE CREATED (7)
PART-TIME LOADING ZONE SPACES (STANDARD PARKING SPACES OUTSIDE OF LOADING TIMES)	
█	EXISTING LOADING ZONE / PARKING SPACES TO BE REMOVED (-3)
█	EXISTING STANDARD PARKING SPACES TO BE CONVERTED TO PART-TIME LOADING ZONES (3)
█	EXISTING LOADING ZONE / PARKING SPACES TO BE RETAINED
CAR SHARE	
█	EXISTING CAR SHARE SPACES TO BE REMOVED (-3)
█	EXISTING CAR SHARE SPACES TO BE RETAINED
BUS ZONES	
█	BUS ZONE TO BE REMOVED
█	BUS ZONE TO BE RETAINED

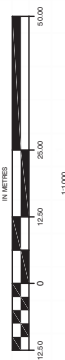
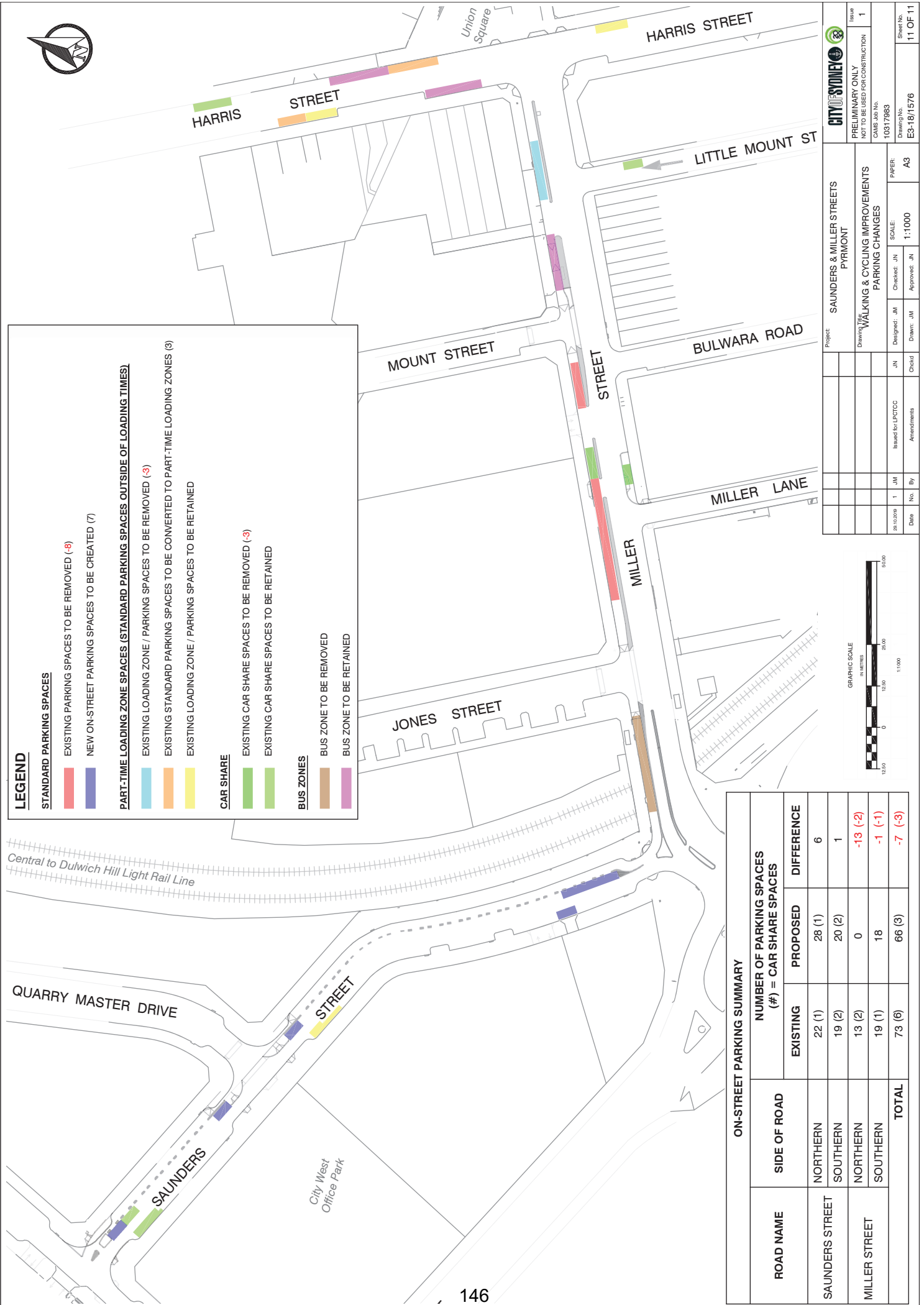

ON-STREET PARKING SUMMARY				
ROAD NAME	SIDE OF ROAD	NUMBER OF PARKING SPACES (#) = CAR SHARE SPACES		
		EXISTING	PROPOSED	
SAUNDERS STREET	NORTHERN	22 (1)	28 (1)	6
	SOUTHERN	19 (2)	20 (2)	1
MILLER STREET	NORTHERN	13 (2)	0	-13 (-2)
	SOUTHERN	19 (1)	18	-1 (-1)
TOTAL		73 (6)	66 (3)	-7 (-3)

Project: SAUNDERS & MILLER STREETS PYRMONT		Issue: 1
Drawing Title: WALKING & CYCLING IMPROVEMENTS PARKING CHANGES		Issue: 1
Issue No: 10017983	Design No: E3-18/1576	Sheet No: 11 OF 11
Scale: 1:1000	Check: JN	Drawn: JM
Scale: 1:1000	Checked: JM	Drawn: JM
Scale: 1:1000	Approved: JN	Drawn: JM
Scale: 1:1000	Checked: JM	Drawn: JM
Scale: 1:1000	Approved: JN	Drawn: JM

DATE IN SERVICE : 10/11/1996

DRAWN BY CADD
DO NOT AMEND MANUALLY

TCS 3230

NOTES

- 1. This file is a CADD file.
- 2. Signal STOP (S) and AHEAD (A) phases on posts 1, 2 and 9.
- 3. Signal STOP (S) and AHEAD (A) phases on posts 2, 4, 6, 8, 9 and 14.
- 4. Audit trailable flash buttons are provided on posts 2, 4, 6, 8, 9 and 14.
- 5. For civil construction details of see drawing No. E3-181576 prepared by City of Sydney.
- 6. CCTV camera provided on Post 5.
- 7. Trees on approaches to the intersection are to be regularly inspected and trimmed by Council to minimise lantern obstruction.

POST	TYPE	LENGTH	OFFSET	REMARKS
1	2	4.1	-	Existing
2	2	4.1	1.0	Existing
3	2	4.1	2.2	Existing
4	6	-	1.0	Existing
5	2	4.1	0.8	Existing
6	6	4.1	1.5	Existing
7	2	4.1	1.0	Existing
8	2	4.1	1.0	Existing
9	2	4.1	1.3	Existing
10	2	4.1	1.9	Existing
11	2	4.1	1.8	Existing
12	2	4.1	1.2	Existing
13	2	4.1	1.9	Existing
14	2	4.1	1.0	Existing

DETECTOR SPECIFICATION

Detector	Specifications			
	FN	ALL	A/E1	REMARKS
A1	SGPS	A	A	
A2	DS	—	—	
	FN	A/PR	A/E2	
B	DS	—	—	
	FN	B/L	B/E1	
C1	DS	—	—	
	FN	C/L	C/E1	
C2	DS	—	—	
	FN	C/PR	C/E2	
D	DS	—	—	
	FN	D/L	D/E1	
P1	DS	—	—	
	FN	A/PR	O/L	
P2	SGPS	P1(WALK)	A/P(WALK)	
	DS	—	B,C,D	
P3	SGPS	P2(WALK)	C/P(WALK)	
	DS	—	X & B, D	
P.B.	FN	B/PR	A/L	
	SGPS	P3(WALK)	B/P(WALK)	
P.B.	DS	—	A,C,D	

SIGNAL GROUP PHASE CHART

SIGNAL GROUP	PHASE DURING WHICH GREEN DISPLAYED				REMARKS
	A	B	C	D	
V1	X				
V2		X			
V3			X		
V4				X	Ref for walk and part clearance (special timer) if P3 demanded.
V5				X	
V6				X	Timed Rear Arrow protection for P1 pedestrians
V7				X	Timed Rear Arrow protection for P2 pedestrians
P1				X	Auto Introduction of P1 pedestrians subject to XS F 1
P2				X	Auto Introduction of P2 pedestrians subject to XS F 2
P3				X	Auto Introduction of P3 pedestrians subject to XS F 3

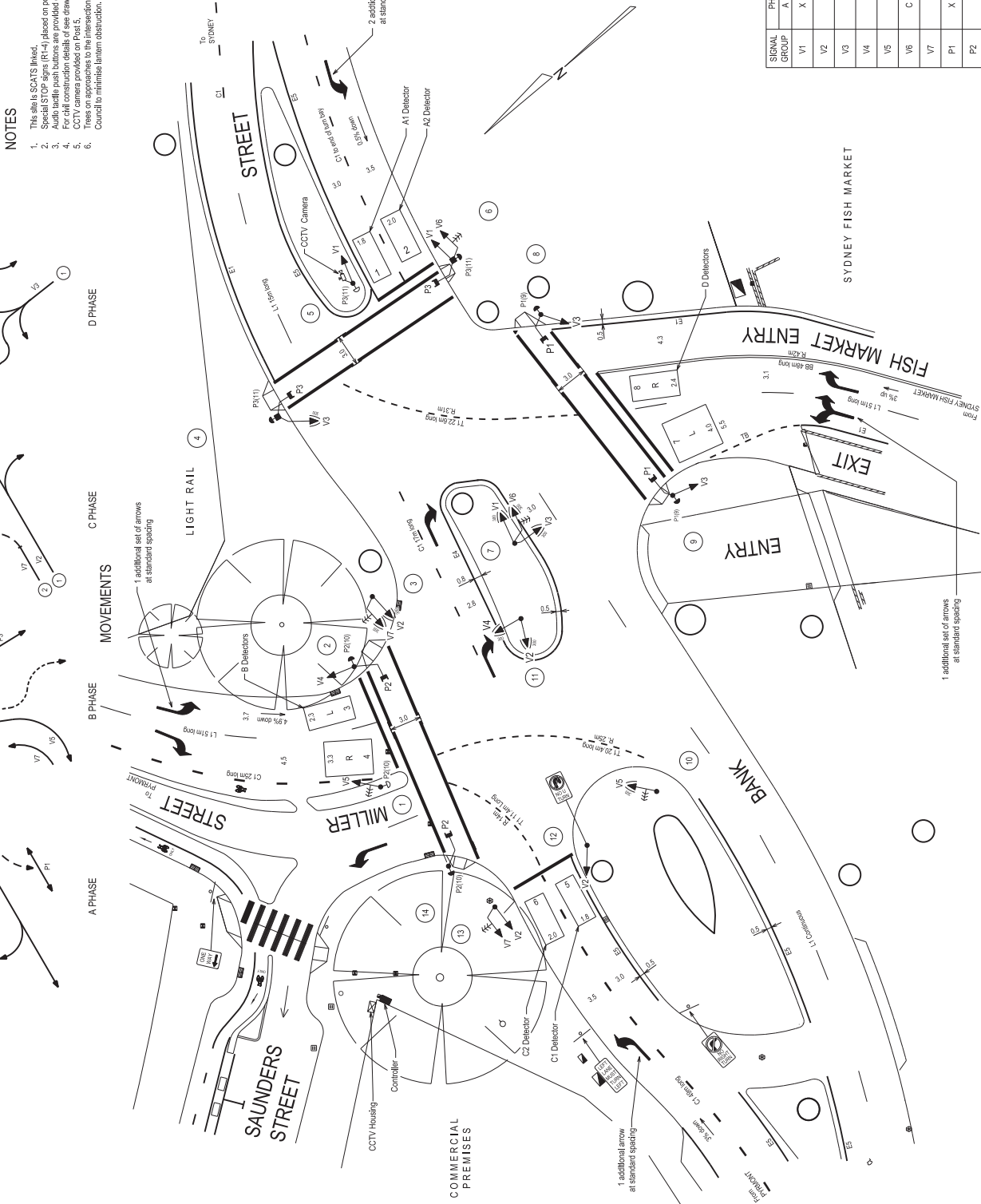

EXISTING	PROPOSED
<input type="checkbox"/>	<input checked="" type="checkbox"/>
CADD FILE: VV3230_4.dgn	
SCALE: 1:1200	
FILE: SF2014012716	
REG No: DS2014/003618	TCS No: 3230
ISSUE A	SHEET 4

DESIGN LAYOUT	ROADS AND MARITIME SERVICES
MILLER STREET AND FISH MARKET ENTRY PYRMONT	TRAFFIC SIGNALS AT BANK STREET
	SYDNEY COUNCIL AREA
	SYDNEY FISH MARKET

REFERENCE PLANS	DESIGN APPROVAL	RMS RECOMMENDATIONS	RMS ACCEPTANCE
SYMBOLS AND LEGEND: STOP, STOP WAIVE, COMBAT, COMBAT BARS, POWER POLE, STOP WAIVE, COMBAT BARS, STOP WAIVE, COMBAT BARS	NAME: [Signature], DATE: 20/08/2014, ROAD DELAY SOLUTIONS PTY LTD	NAME: [Signature], DATE: 20/08/2014, NETWORK OPERATIONS	NAME: [Signature], DATE: 20/08/2014, NETWORKS AND MARKET SERVICES

PUBLIC UTILITY LEGEND	SYMBOLS AND LEGEND	SYMBOLS AND LEGEND	SYMBOLS AND LEGEND
STOP WAIVE, COMBAT, COMBAT BARS, POWER POLE, STOP WAIVE, COMBAT BARS	SYMBOLS AND LEGEND: STOP, STOP WAIVE, COMBAT, COMBAT BARS, POWER POLE, STOP WAIVE, COMBAT BARS	SYMBOLS AND LEGEND: STOP, STOP WAIVE, COMBAT, COMBAT BARS, POWER POLE, STOP WAIVE, COMBAT BARS	SYMBOLS AND LEGEND: STOP, STOP WAIVE, COMBAT, COMBAT BARS, POWER POLE, STOP WAIVE, COMBAT BARS

A ORIGINAL ISSUE

DRAWN BY CADD
DO NOT AMEND MANUALLY

NOTES

- This site is SCATS linked.
- Signals are provided on posts 1, 2, 3, 5, 6 and 7. Bicycle push button provided on Post 4.
- Signal for Stop Sign (R44) placed on Post 1.
- Keel ramps are constructed in accordance with City of Sydney guidelines.
- Separated cycleway to be in accordance with CoS and RMS NSW Bicycle Guidelines.
- Bicycle detectors to be in accordance with RMS drawings VCO05-38A and VCO05-38A.
- Automatic introduction of C phase subject to presence of ASF 15 in mainline.
- Trees on approach to the intersection are to be regularly inspected and trimmed by Council to minimise lanem loss.
- For details of civil construction see City of Sydney drawings E34/181576.

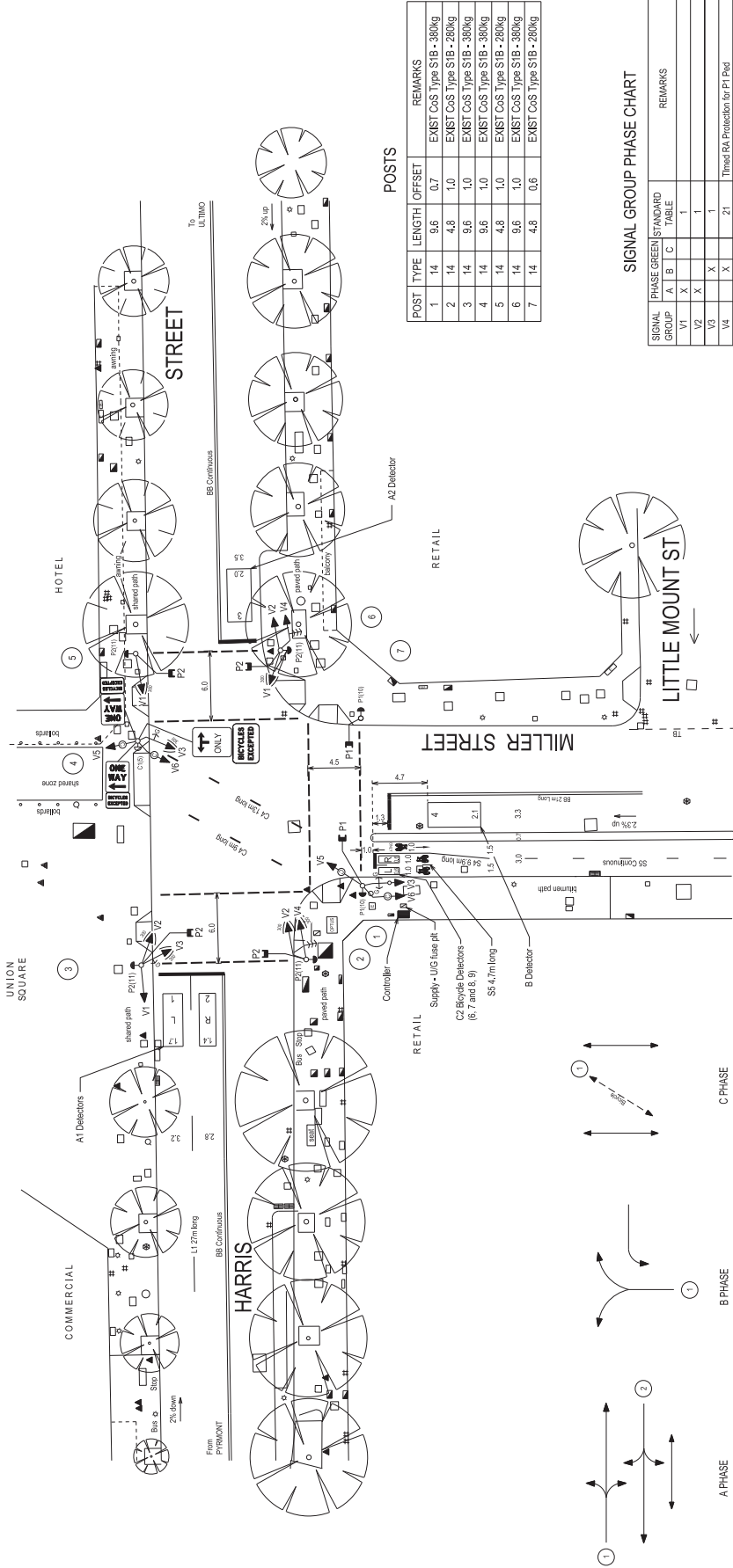

POSTS

POST	TYPE	LENGTH	OFFSET	REMARKS
1	14	9.6	0.7	EXIST CoS Type S1B - 380kg
2	14	4.8	1.0	EXIST CoS Type S1B - 280kg
3	14	8.6	1.0	EXIST CoS Type S1B - 380kg
4	14	9.6	1.0	EXIST CoS Type S1B - 380kg
5	14	4.8	1.0	EXIST CoS Type S1B - 280kg
6	14	9.6	1.0	EXIST CoS Type S1B - 380kg
7	14	4.8	0.6	EXIST CoS Type S1B - 280kg

SIGNAL GROUP PHASE CHART

SIGNAL GROUP	PHASE GREEN STANDARD TABLE			REMARKS
	A	B	C	
V1	X	X	1	
V2	X	X	1	
V3	X	X	1	
V4	X	X	21	Threat RA Protection for P1 Ped
V5	X	X	1	
V6	X	X	1	
P1	X	X	2	Automatic introduction of P1 ped subject to presence of ASF1
P2	X	X	20	Automatic Introduction

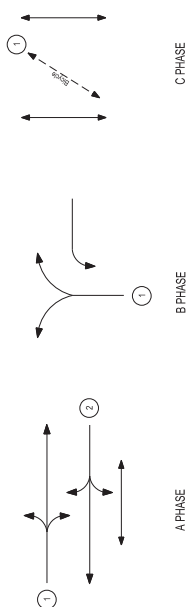

ROADS AND MARITIME SERVICES

SYDNEY COUNCIL AREA
TRAFFIC SIGNALS AT
HARRIS STREET
AND MILLER STREET
PYRMONT

EXISTING PROPOSED

CADD FILE: V0122_18A.dgn

SCALE: 1:1250

FILE: SF2013/168775

REG. NO.: DS2013/001746

TCS No.: 0122

SHEET: 18

ISSUE: A

SHEETS: 150

DATE: 2017

DESIGN APPROVAL: [Signature]

DESIGN APPROVED: [Signature]

RMS RECOMMENDATION: [Signature]

RMS ACCEPTANCE: [Signature]

REFERENCE PLANS: [List of drawings]

DATE: 2017

COMMENTS: [List of notes]